

DA-434 CONVEYOR CHAIN

The DA-434 series chain is the strongest conveyor chain on the market today. The DA-434 chain is designed to run on a 5 tooth sprocket in most applications for quieter performance. The DA-434 is widely used in coal, potash, rock, limestone, and gypsum mining.

DA-4342 CHAIN UNIT

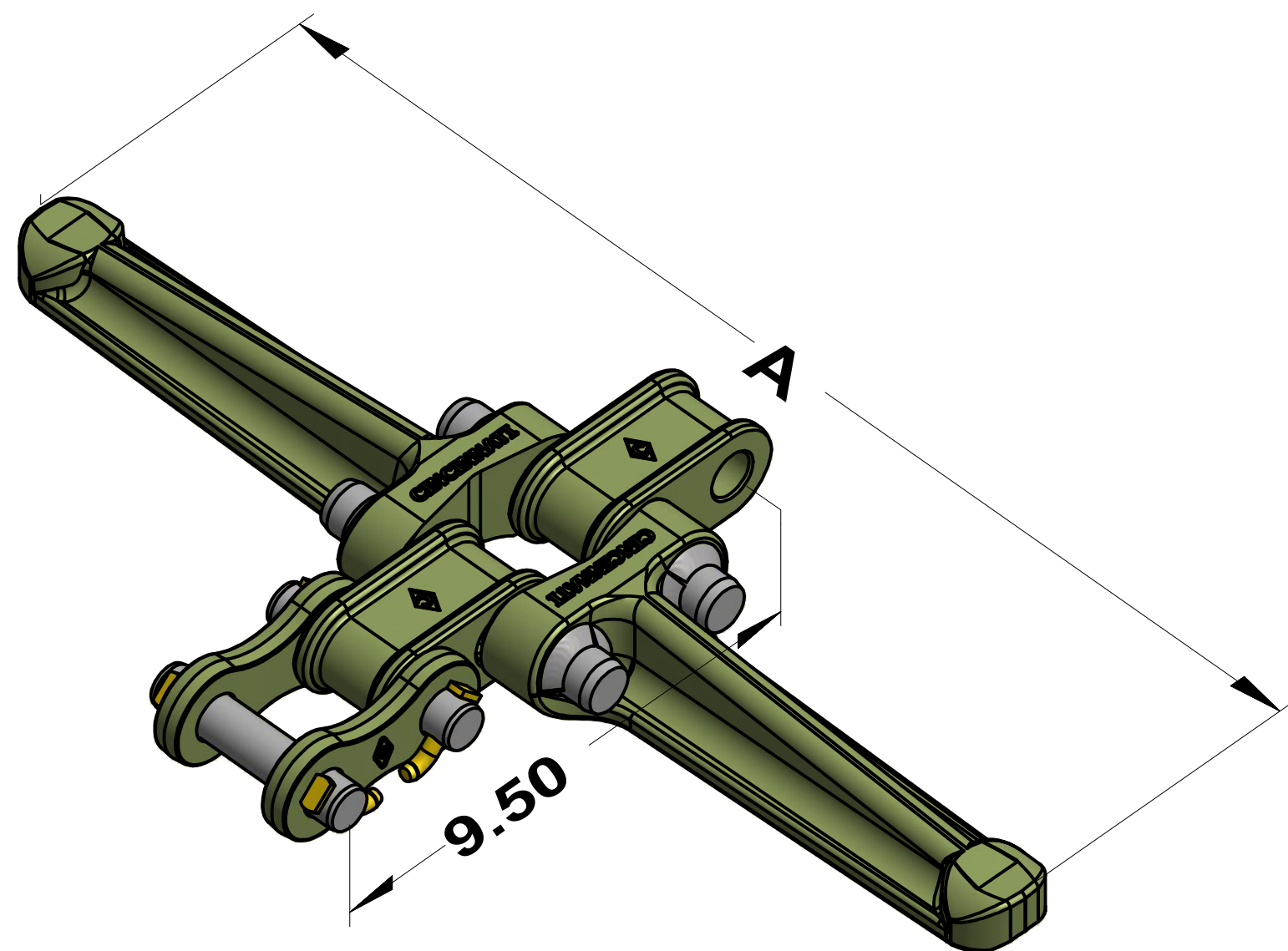

FLIGHT SECTION

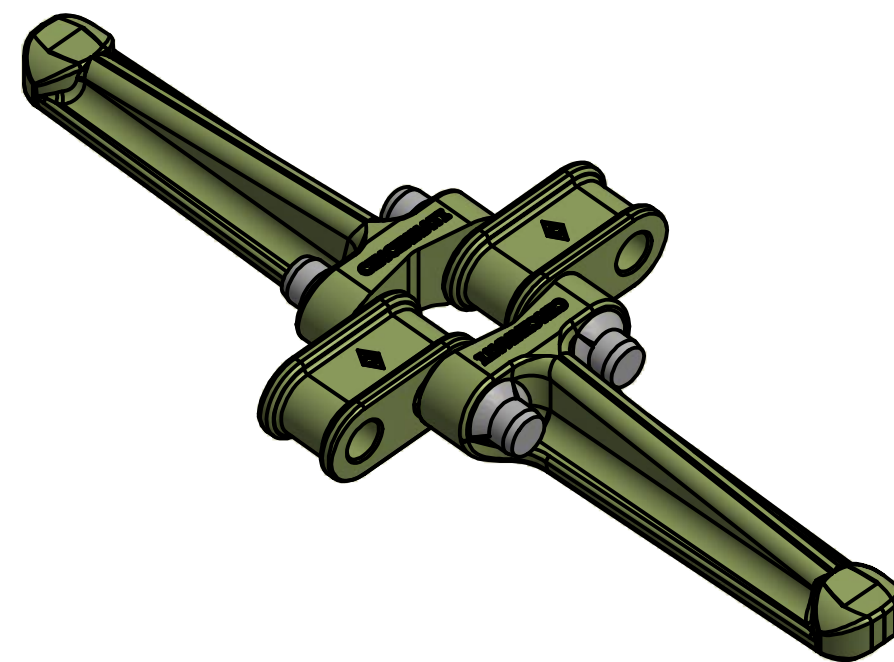

C-2228
DA-434 CONNECTOR
(or roller link)

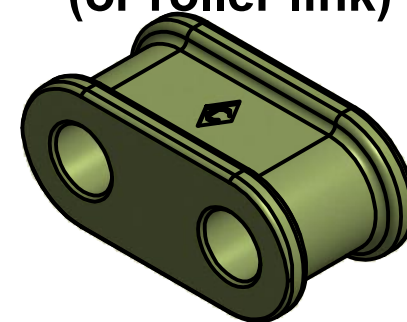

DA-434 CHAIN UNIT

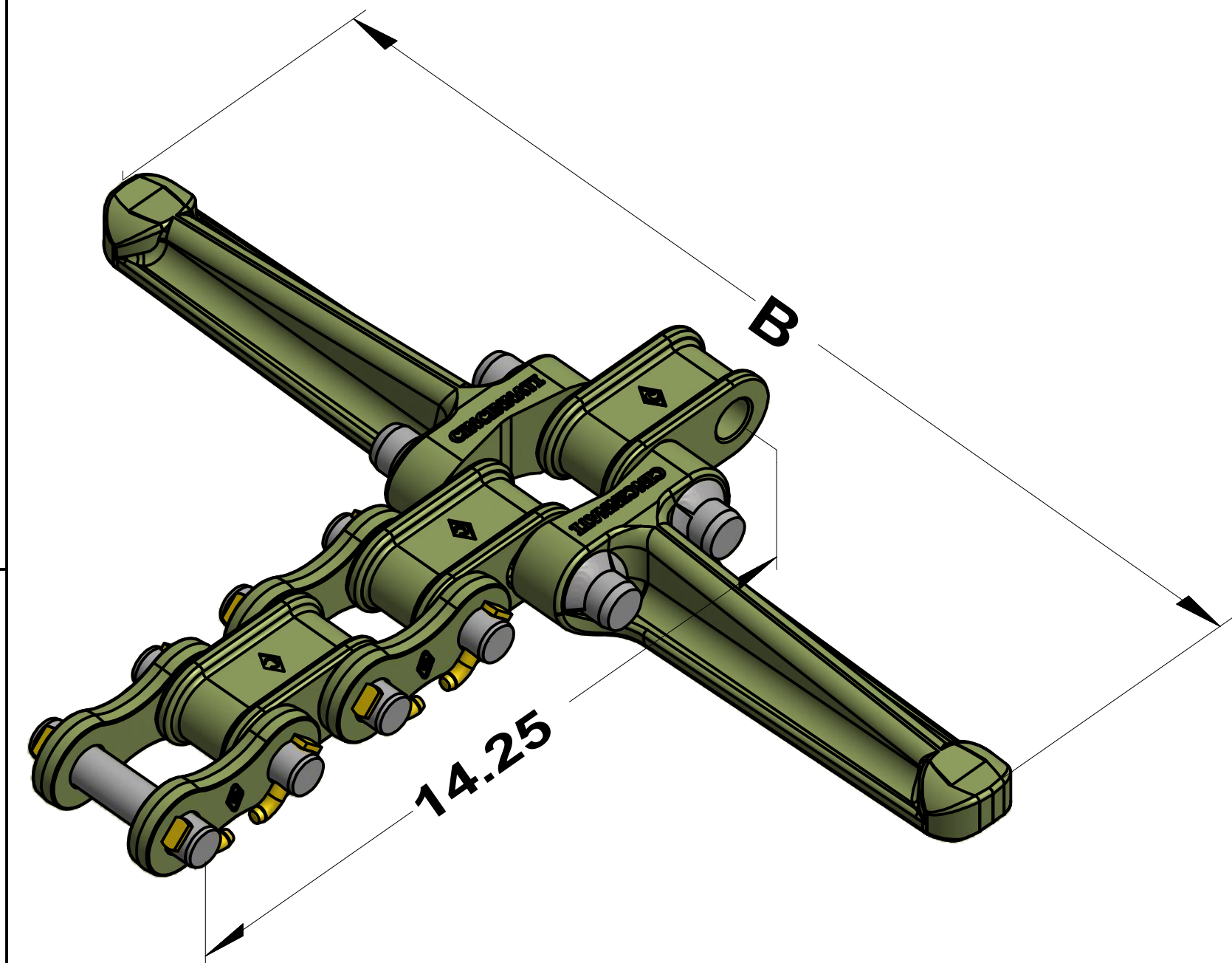

DA-4342 CONVEYOR CHAIN SELECTION CHART

MODEL NO.	*A - WIDTH	CHAIN UNIT	FLIGHT SECTION
DA-4342-B	21-7/8	C-12909	C-5309

C-11514
DA-434 SIDE STRAP ASSEMBLY
(or connecting links)

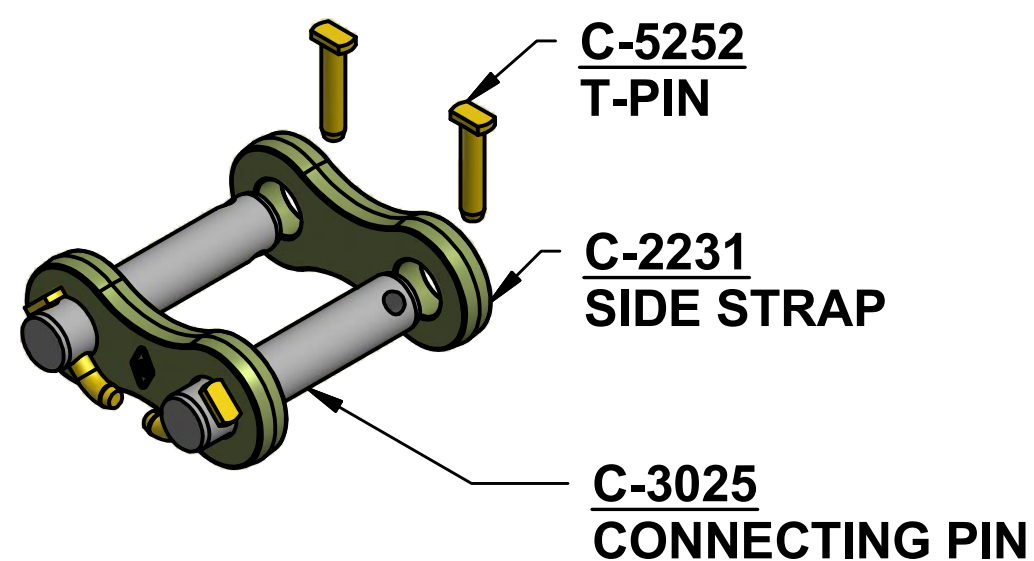

DA-434 CONVEYOR CHAIN SELECTION CHART

MODEL NO.	*B - WIDTH	CHAIN UNIT	FLIGHT SECTION
DA-434-B	21-7/8	C-5310	C-5309
DA-434-Q	19-5/8	C-14733	C-14732
DA-434-H	19	C-6369	C-6368

*CHAINS WIDTHS OTHER THAN THOSE LISTED ARE AVAILABLE UPON REQUEST