

DA-550 CONVEYOR CHAIN

The DA-550 series chain is the strongest conveyor chain on the market today. The DA-550 chain is designed to run on a 5 tooth sprocket in most applications for quieter performance. The DA-550 is widely used in coal, potash, rock, limestone, and gypsum mining.

DA-5502 CHAIN UNIT

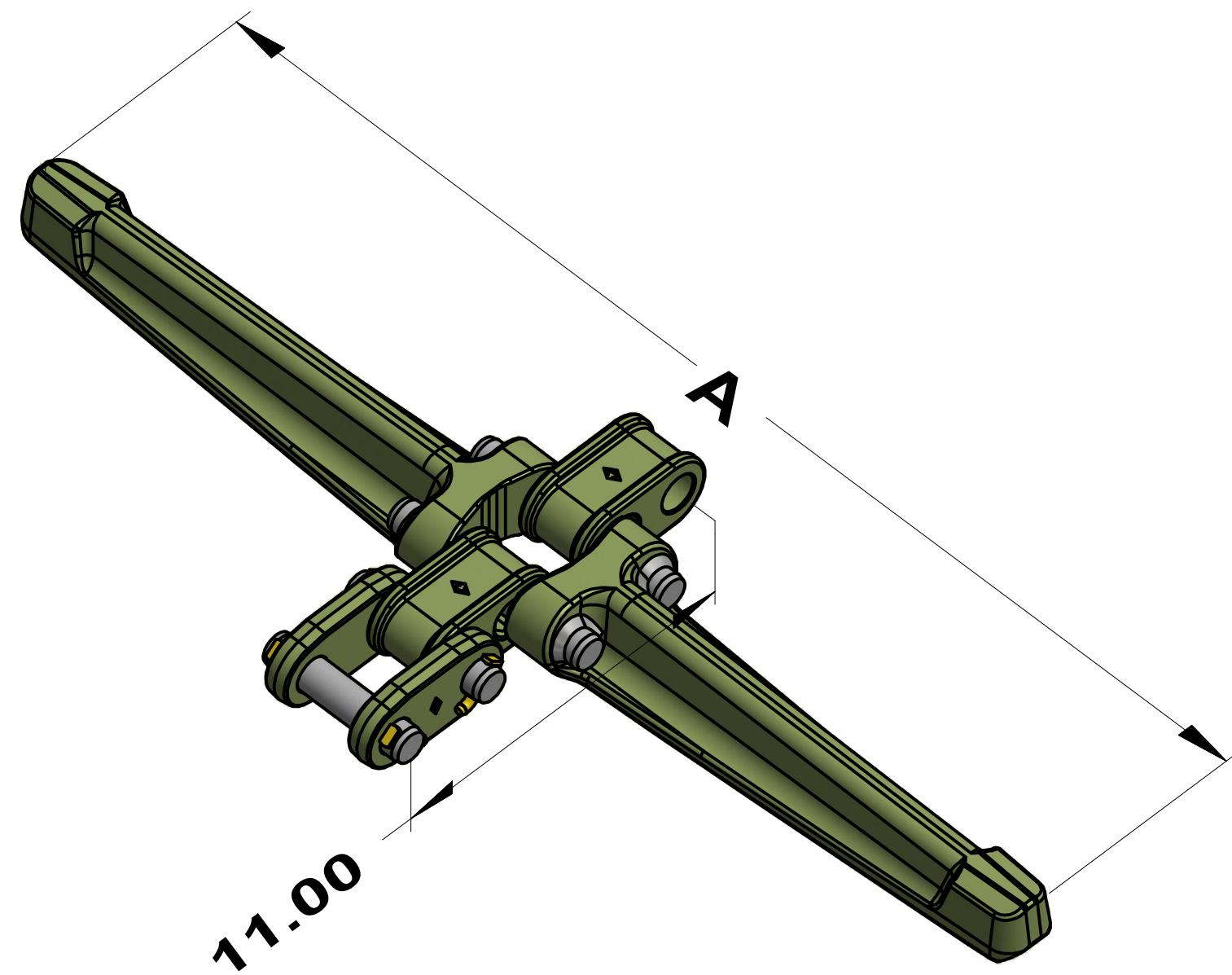

FLIGHT SECTION

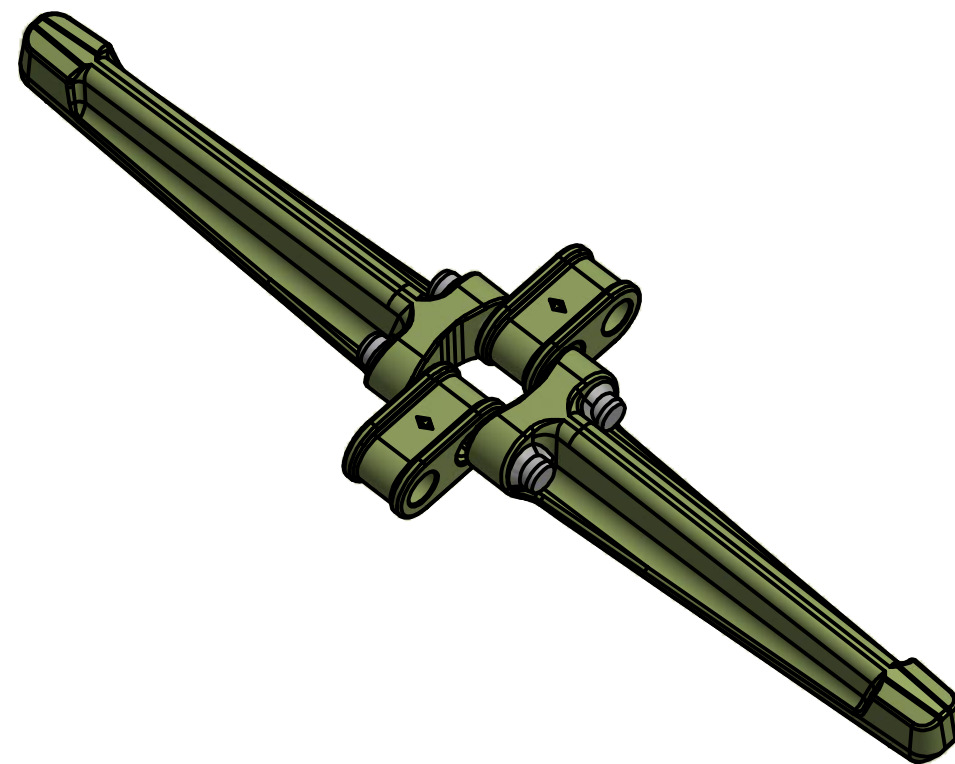

C-11520
DA-550 CONNECTOR
(or roller link)



DA-550 CHAIN UNIT

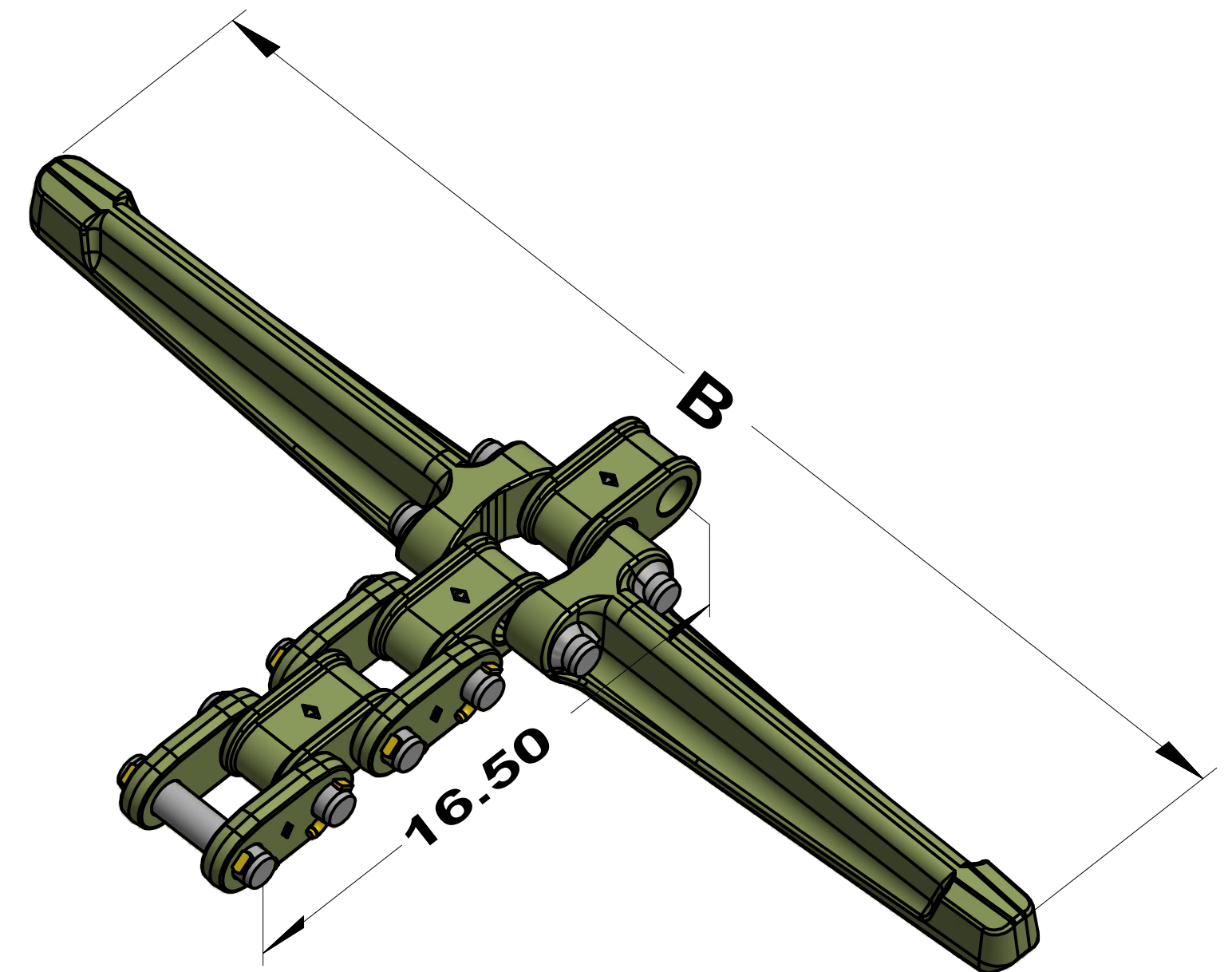

DA-5502 CONVEYOR CHAIN SELECTION CHART

MODEL NO.	*A - WIDTH	CHAIN UNIT	FLIGHT SECTION
DA-5502	27-1/2	C-12393	C-11575
DA-5502-A	36-1/8	C-12492	C-11580
DA-5502-E	23	C-12845	C-11842
DA-5502-L	33-1/2	C-12176	C-12154
DA-5502-LX	33-1/2	C-13823	C-13834
DA-5502-CX	28	C-14897	C-14896

C-11578 DA-550 SIDE STRAP ASSEMBLY (or connecting links)

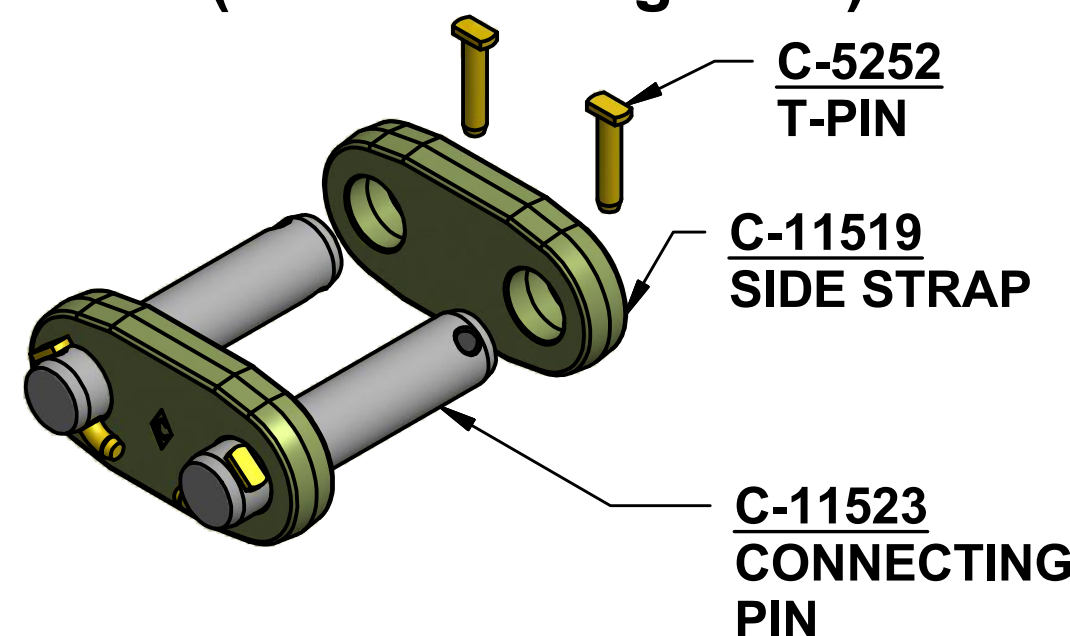

DA-550 CONVEYOR CHAIN SELECTION CHART

MODEL NO.	*B - WIDTH	CHAIN UNIT	FLIGHT SECTION
DA-550	27-1/2	C-11577	C-11575
DA-550-A	36-1/8	C-11581	C-11580
DA-550-E	23	C-11843	C-11842
DA-550-H	30-1/2	C-12842	C-12843
DA-550-K	22	C-12006	C-12005
DA-550-L	33-1/2	C-12155	C-12154

*CHAINS WIDTHS OTHER THAN THOSE LISTED ARE AVAILABLE UPON REQUEST