

# DA-615 CONVEYOR CHAIN

The DA-615 series chain is the strongest conveyor chain on the market today. The DA-615 chain is designed to run on a 5 tooth sprocket in most applications for quieter performance. The DA-615 is widely used in coal, potash, rock, limestone, and gypsum mining.

**DA-6152 CHAIN UNIT**

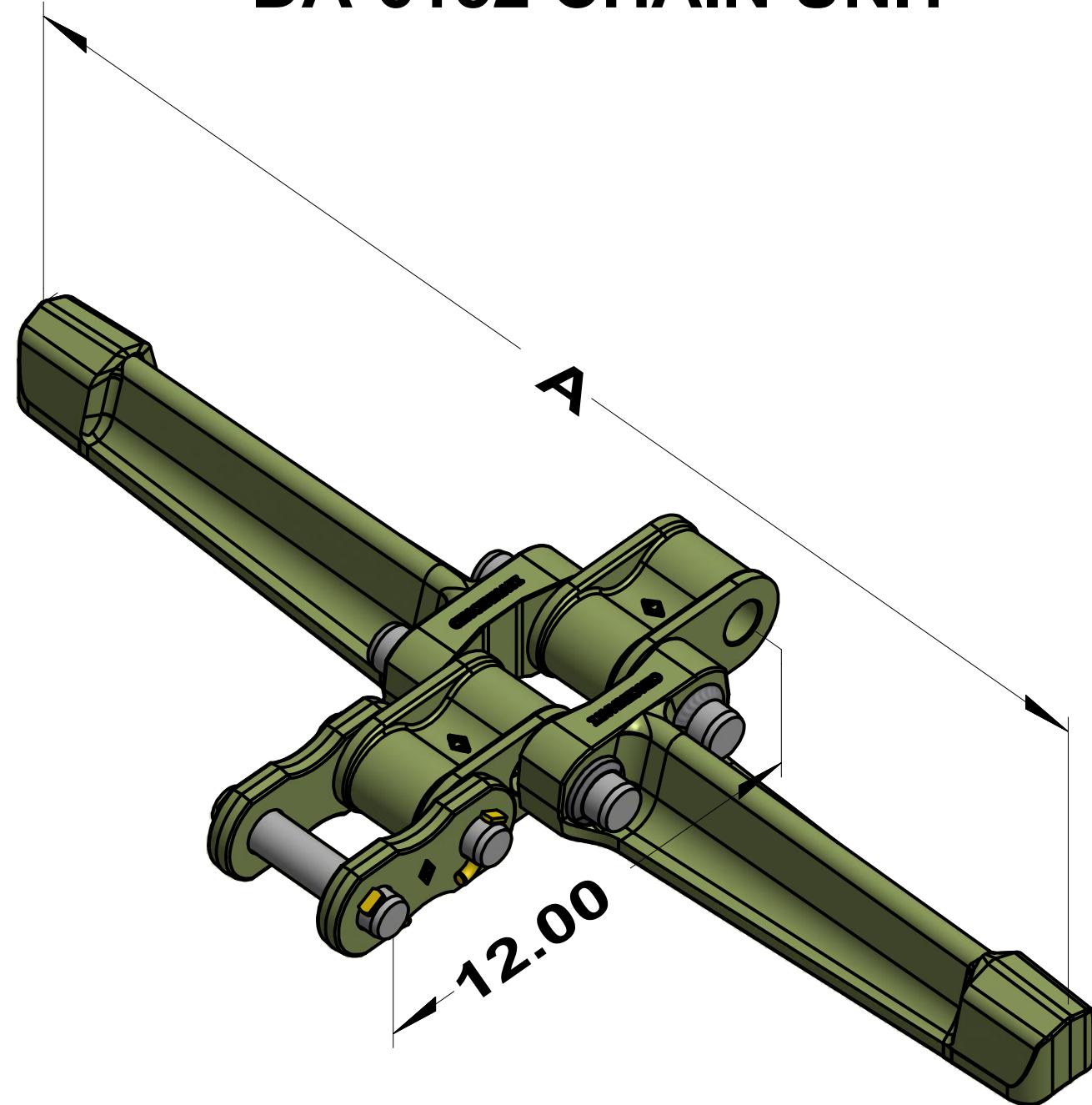

**FLIGHT SECTION**

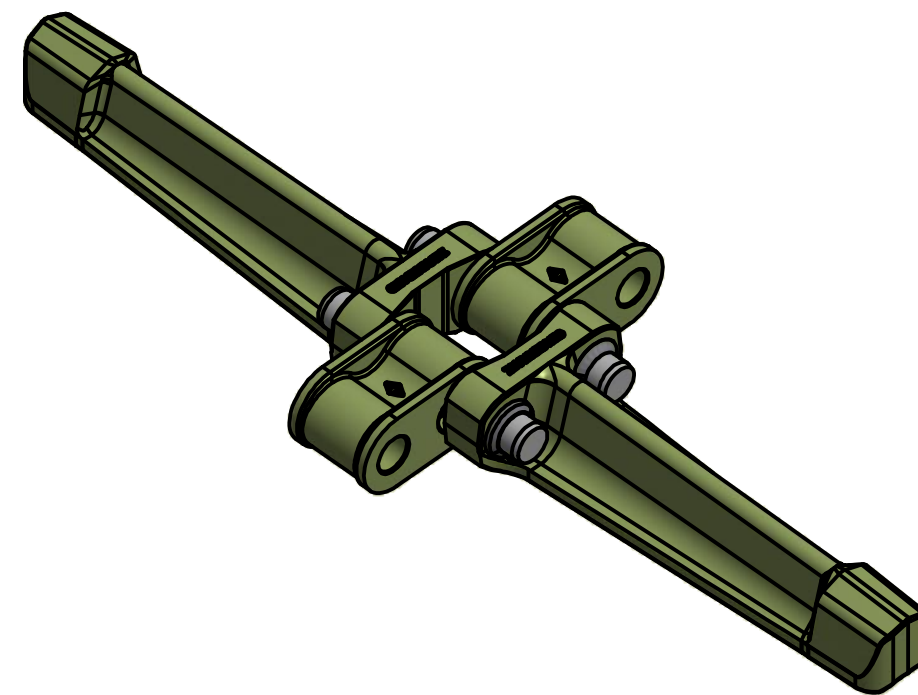

**DA-615 CHAIN UNIT**

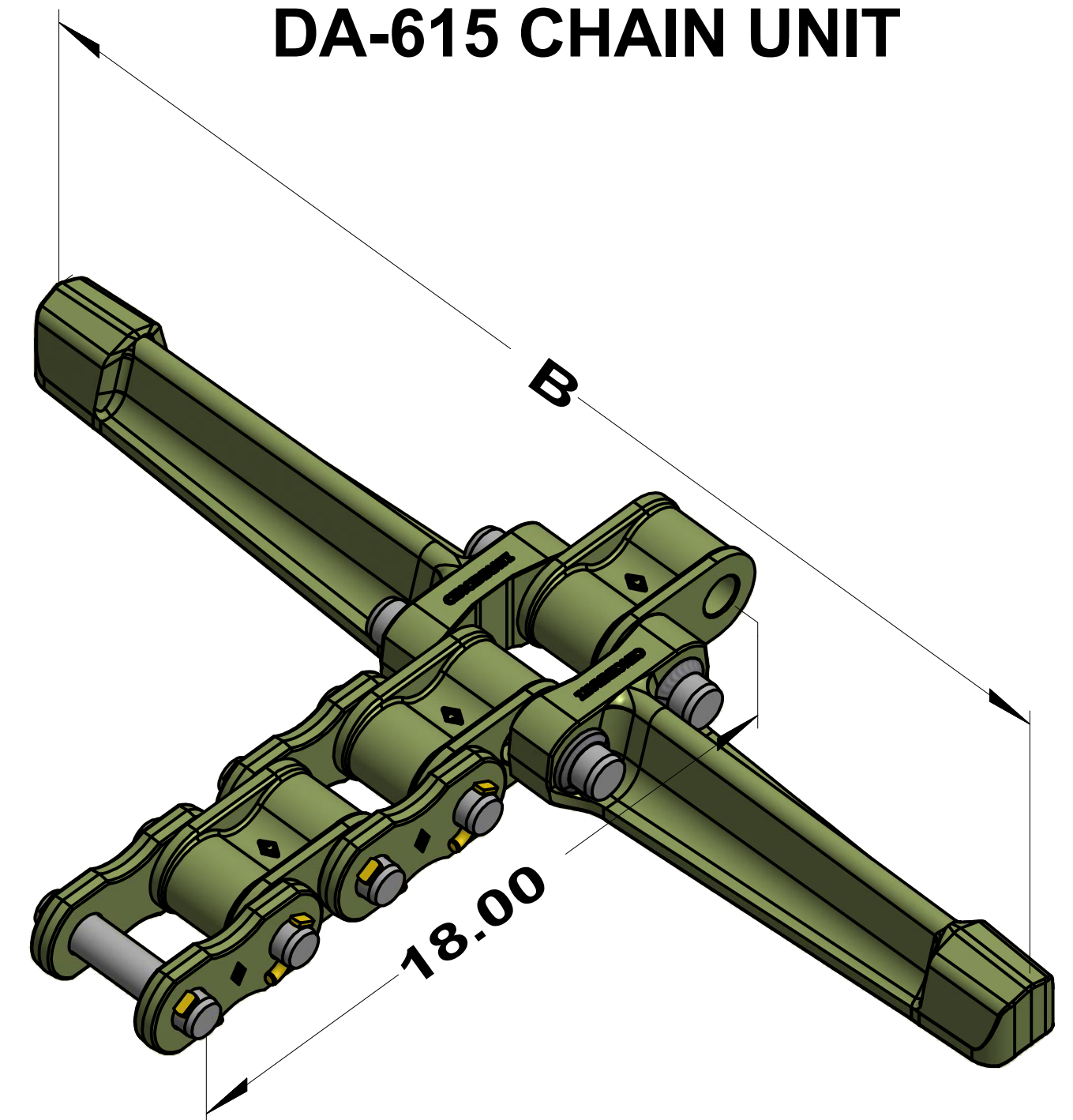

**C-6417**  
**DA-615 CONNECTOR**  
(or roller link)

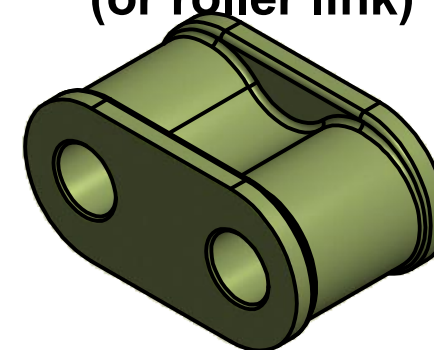

**DA-6152 CONVEYOR CHAIN SELECTION CHART**

MODEL NO.	*A - WIDTH	CHAIN UNIT	FLIGHT SECTION
DA-6152-A	34	C-13316	C-7707

**C-11187**  
**DA-615 SIDE STRAP ASSEMBLY**  
(or connecting links)

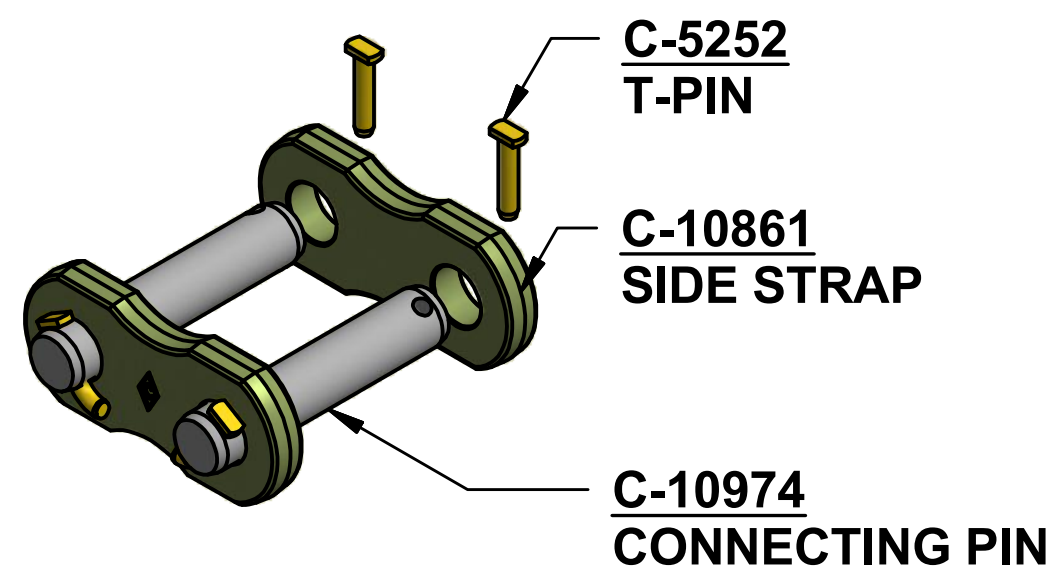

**DA-615 CONVEYOR CHAIN SELECTION CHART**

MODEL NO.	*B - WIDTH	CHAIN UNIT	FLIGHT SECTION
DA-615-F	32	C-12562	C-12561
DA-615-R	23	C-12715	C-12714
DA-615-Z	29-1/2	C-13549	C-13548
DA-615-VA	29	C-14236	C-14235

\*CHAINS WIDTHS OTHER THAN THOSE LISTED ARE AVAILABLE UPON REQUEST